

Cleaning guide

To always get the best performance from the Dyson Airblade Wash+Dry hand dryer, it's important to regularly clean it and check for blockages.

Clean the sensors

Wipe sensors using a soft cloth and non-abrasive cleaner then place cleaning cap over sensors to prevent activation.

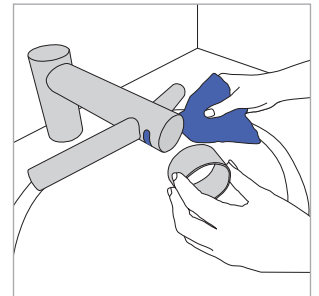

Clean the machine

Clean all tap surfaces, sink, mirror and any walls or counter tops. When complete REMEMBER to remove cleaning cap.

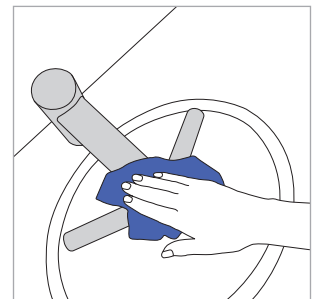

Clean and check for blockages

REGULARLY clean air inlets on base of motor bucket (under sink). Ensure plughole in sink is free from blockages so water can drain freely.

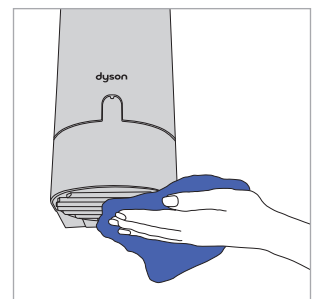

What to use to clean the Dyson Airblade Wash+Dry hand dryer

Important: Do not pressure wash the Dyson Airblade Wash+Dry hand dryer.

Types of cleaning

Routine cleaning of light soiling and fingerprints.

Stubborn marks and stains, oil and grease marks.

Water marks.

How to clean

A mild detergent applied with a lint-free cloth. Remove detergent residue with a damp cloth and tap water.

A mild detergent, alcohol or Quaternary ammonium solution, diluted to the manufacturer's guidelines. Remove detergent residue with a damp cloth.

Water marks can be avoided by drying with a dry lint-free cloth.

Do not use

Solvent/oil-based mixes

Alkali-bleach mixes

Foaming ingredients

Bleach or abrasive cleaners

Servicing and support

For more information:

888-397-6622

www.dyson.com

design@dyson.com

For further information about Water supply cleanliness and bacteria growth, please refer to the Owner's manual.